

CITY SCHASLYVE

RESIDENTIAL COMPLEX

LOCATED AT 20a LESI YKRAINKI STREET

SCHASLYVE, KIEV REGION, UKRAINE



DEVELOPER



City State, LLC

Ukraine, Kiev, 01013,
Stroyindustrii Str., 6

tel.: +38 (044) 594 91 84

fax: +38 (044) 545 75 15

ayurkevych@gmail.com

www.citystate.com.ua

GENERAL PLANNER



Prodiz, LLC

Ukraine, Kiev, 01013,
Stroyindustrii Str., 6

tel.: +38 (044) 594 91 90

fax: +38 (044) 545 75 20

v.shershun@prodiz.com.ua

angelina.davydenko@gmail.com

Technical and economics indexes	3
General location scheme	4
Location scheme	5
Transportation scheme	6
Master plan scheme	7
Typical apartments floor plans	8
Facades	9
General views	10

Technical and economics indexes

number	Name	Indexes	Notes
1	Land parcel area	0,84 ha	
2	Construcion footprint area	2 138 sq.m	
3	Number of storeys	5 storeys and mansard	
4	Number of apartments	110	
5	Total building area	13 292 sq.m	
	including:		
6	Total commercial area	3 296 sq.m	
7	Total apartments area	8 420,3 sq.m	
8	Utility premises area	1 575,7 sq.m	

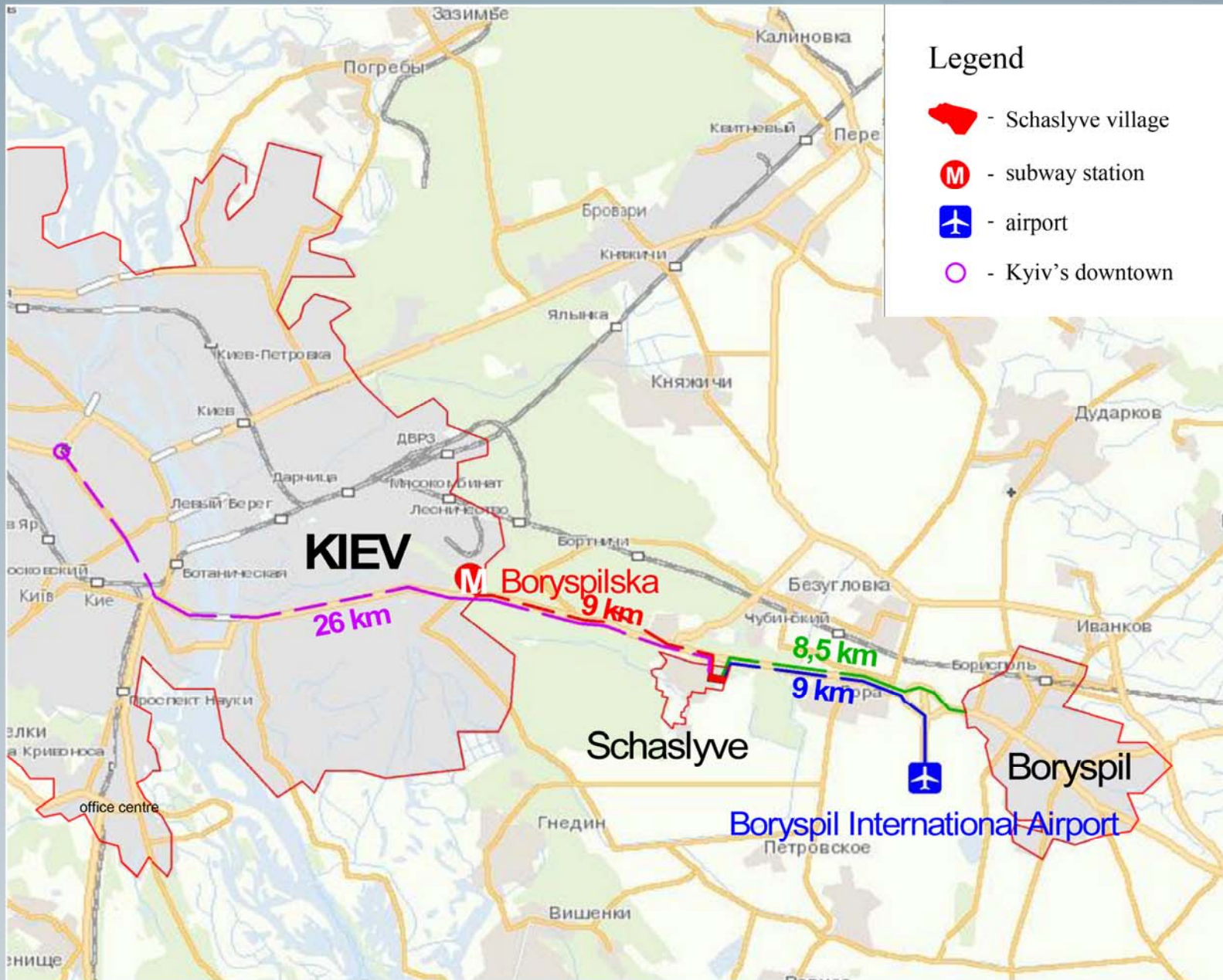



Projected residential complex number 20a

Lenina St

Festyvalna St

Boryspilska St

Lesi Ukrainki St

Lesi Ukrainki St

Lenina St



Master Plan



Explication

number	Name	Notes
1	Residential building number 20a	
2	Parking	
3	Children's plaing ground	
4	Pleasure ground	
5	Sport ground (for table tennis)	
6	Place for garbage containers	



Three-room apartment

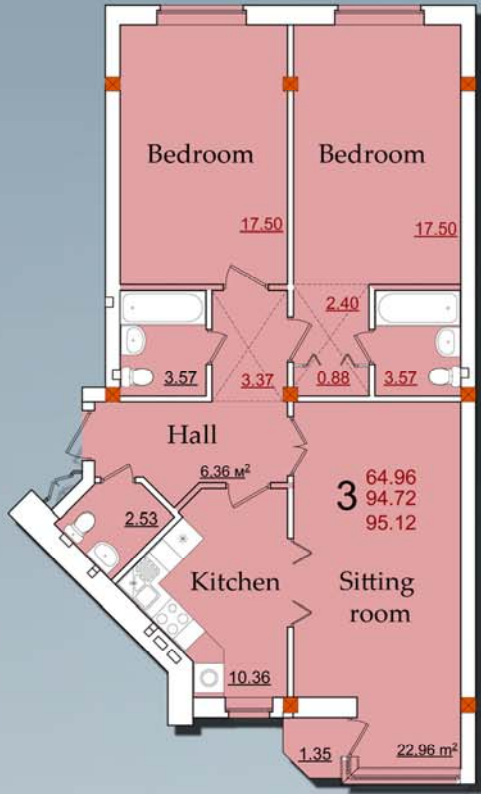

Three-room apartment



Two-room apartment

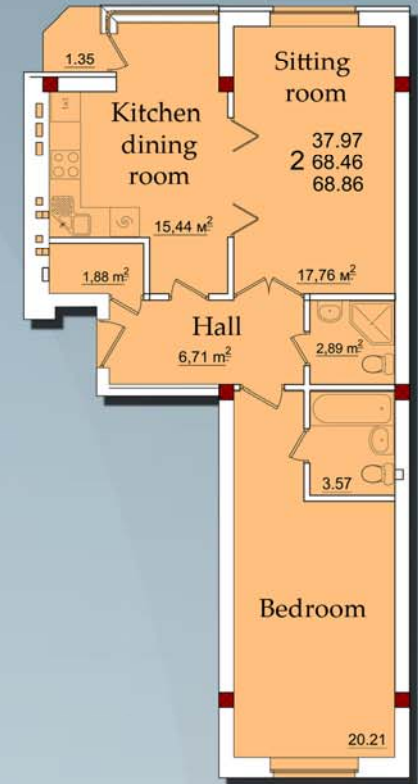

One-room apartment



Two-room apartment



One-room apartment



North Facade



East Facade





